

# Original BMW Accessories. Installation Instructions.



## Retrofit - BMW splash guards BMW X1 (E84)

### Retrofit kit number

82 16 2 155 852	Retrofit kit - splash guards, front
82 16 2 155 851	Retrofit kit - splash guards, rear

### Installation time

The installation time is **approx. 0.5 hours** per axle. The specified time may vary depending on the vehicle condition and equipment.

### Important information

These installation instructions are primarily designed for use within the BMW dealership organisation and by authorised BMW service companies.

In any event, the target group for these installation instructions is specialist personnel trained on BMW cars with the appropriate specialist knowledge.

All work must be completed using the latest BMW repair manuals, circuit diagrams, servicing manuals and work instructions, in a rational order, using the specified tools (special tools) and observing current health and safety regulations.

### In the event of installation or functional problems, limit troubleshooting to 0.5 hours for mechanical jobs and 1.0 hours for electrical jobs.

To avoid unnecessary work and costs, send a corresponding enquiry via the Aftersales Assistance Portal (ASAP) using the technical parts support application.

Please quote the following:

- Vehicle identification number
- Part number of the retrofit kit
- Exact description of the problem
- Work already carried out

Do not archive the hard copy of these installation instructions since daily updates are made by ASAP!

### Pictograms



Denotes instructions that draw your attention to dangers.



Denotes instructions that draw your attention to special features.



Denotes the end of the instruction or information text.

### **Installation information**

The installation instructions describe the procedure on the left-hand side of the vehicle only. The same procedure should be followed analogously on the right-hand side of the vehicle.

All illustrations show LHD vehicles; follow the same procedure for RHD vehicles.

Clean adhesion surfaces with a suitable cleaning agent. They must be free of oil and grease.

When adhering and drying the components, the ambient temperature must be no lower than 15 °C and no higher than 35 °C.

The car can be driven after **approx. 6 hours** and may be driven through a carwash **after 48 hours**.

### **Special tools required**

None

Contents

Section	Page
1 Preparatory work .....	4
2 Installing front splash guards .....	5
3 Installing rear splash guards .....	7
4 Finishing off and coding .....	9

1. Preparatory work

	ISTA No.
Perform quick test	---
Disconnect negative terminal of battery	12 00 ...
<b>Remove the following components beforehand</b>	
None	

## 2. Installing front splash guards

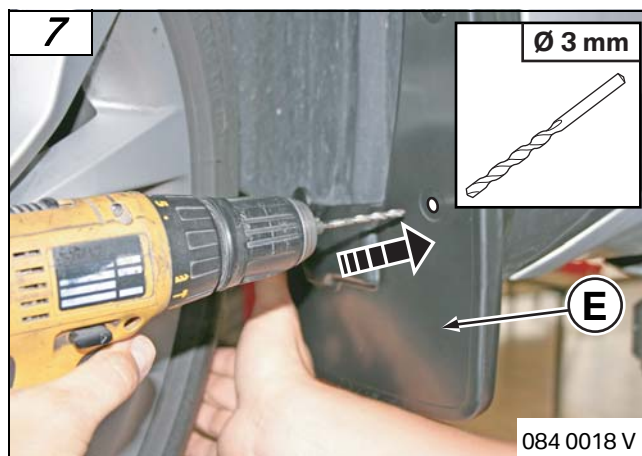
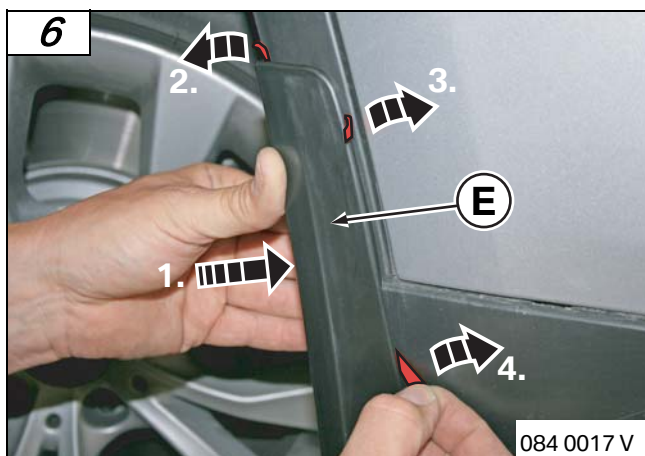
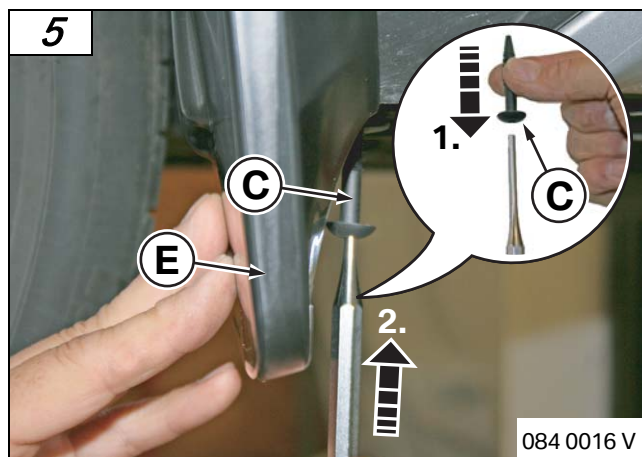
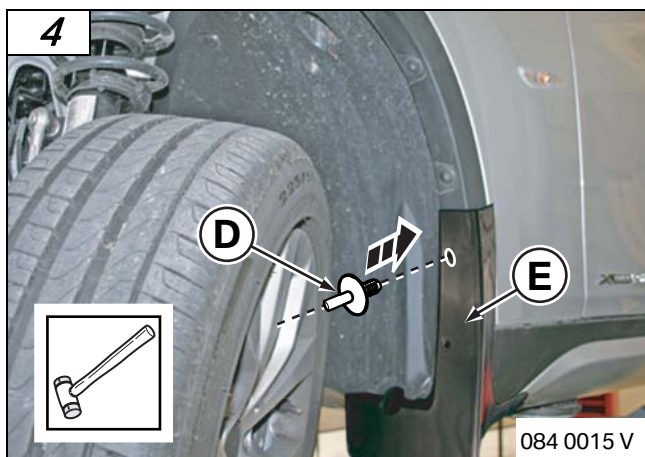
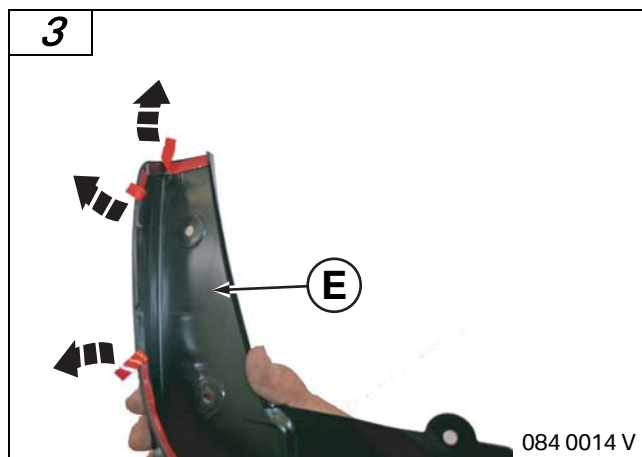
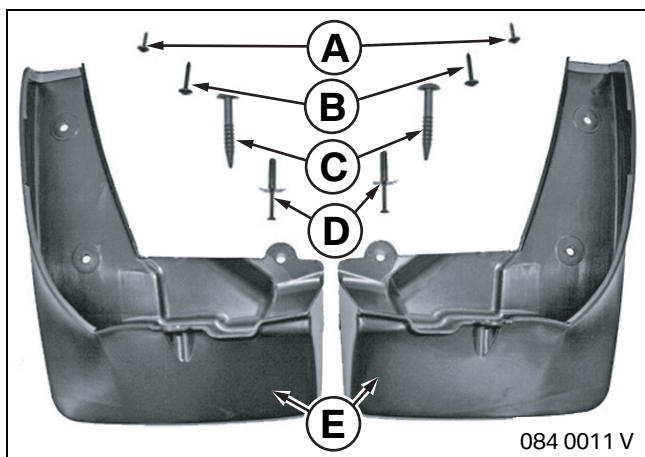

## 2. Installing front splash guards

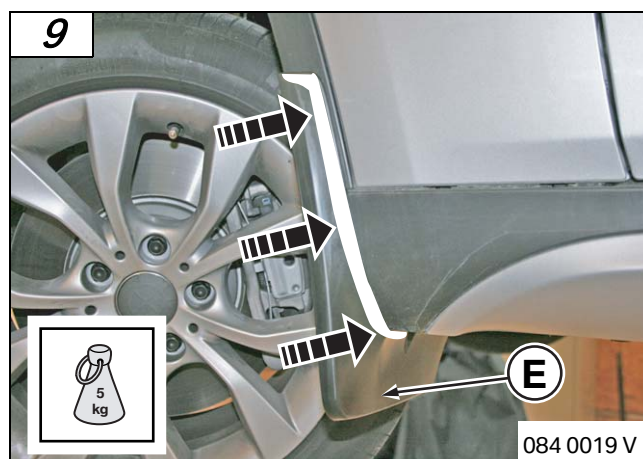
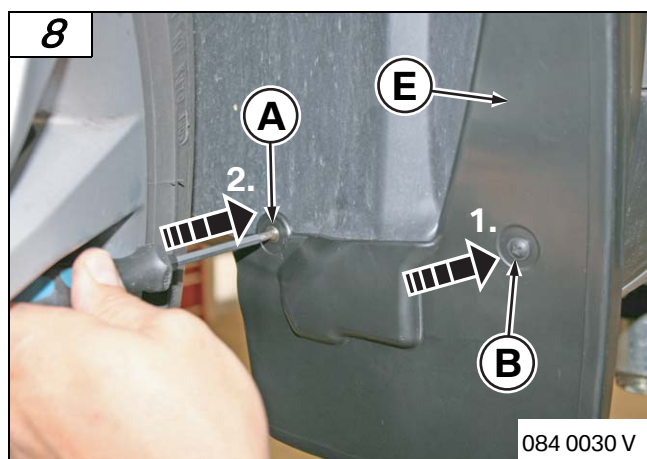

### 3. Installing rear splash guards

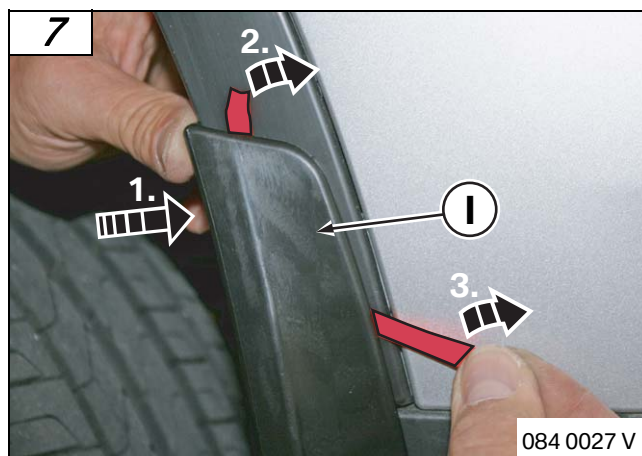
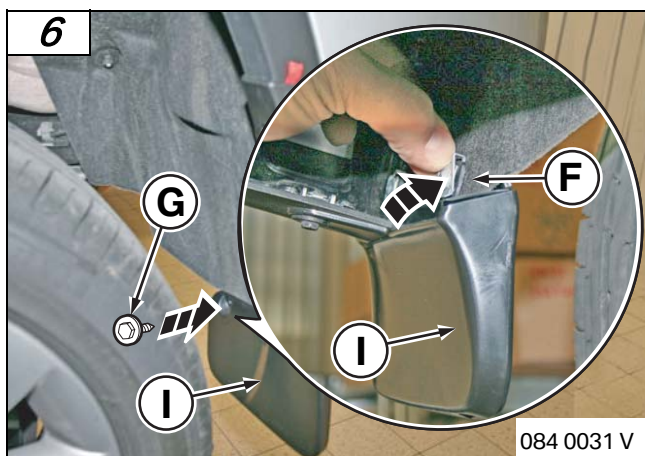
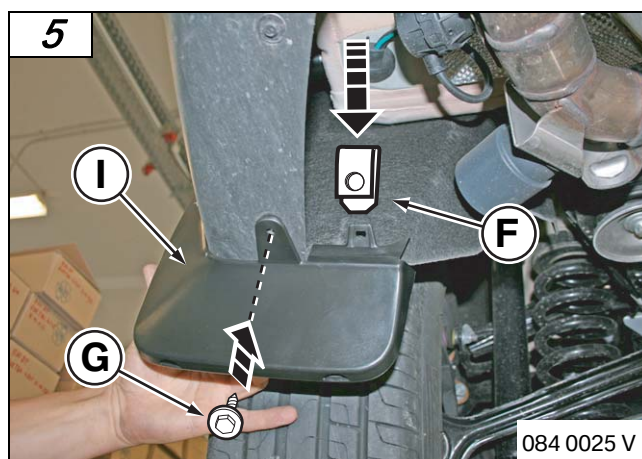
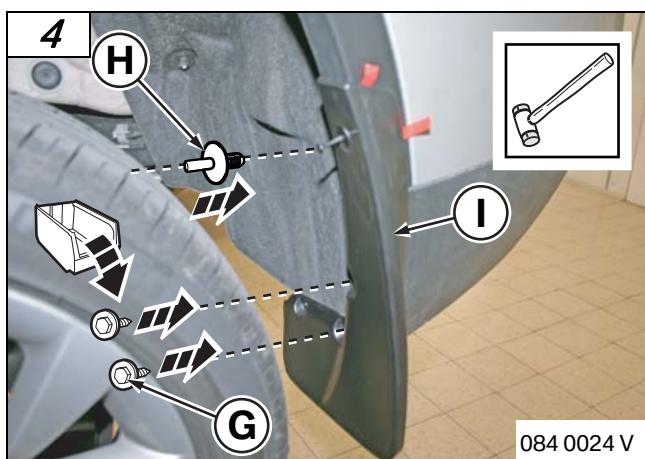
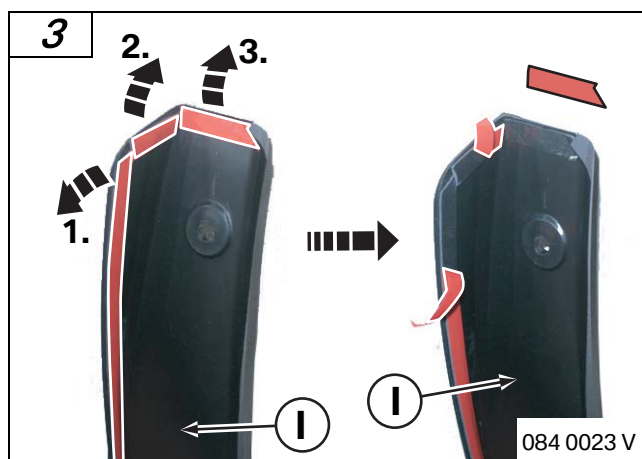
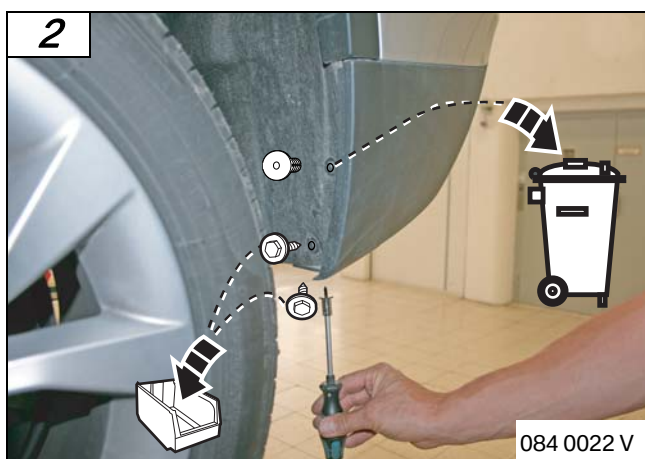
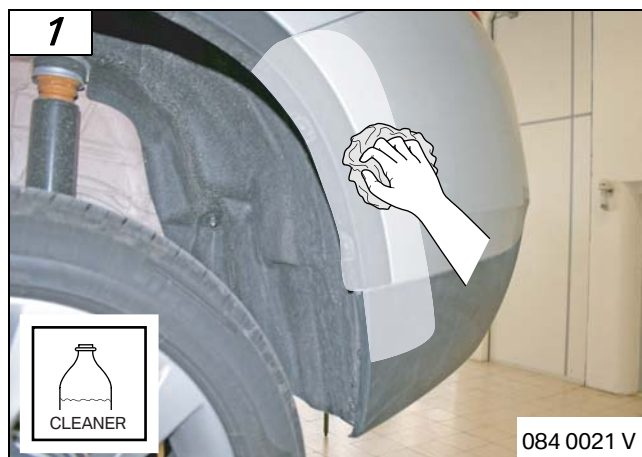
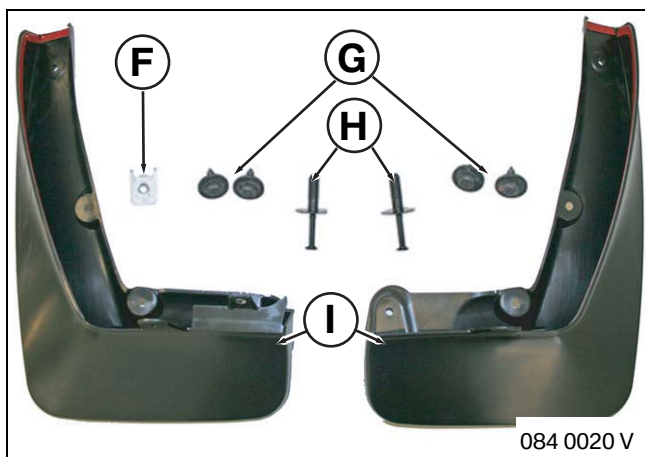

### 3. Installing rear splash guards



## **4. Concluding work and coding**

The retrofit system does not require encoding.

- Reconnect vehicle battery
- Perform quick test